

MODEL NUMBER: F27P38MH	FIXTURE TYPE:	SCALE: 1/4"=1"	FILE NUMBER: W:\PRODUCT\FUND...\SUBMIT...\F27P38MH.dwg	DATE: 02/12/08	NO.	REVISIONS DESCRIPTION	BY	DATE
PROJECT NAME:	APPROX. WEIGHT: 8.4 lbs/3.8 kg	DRAWN BY: KMR	CK'D BY:	FIXTURE DESCRIPTION: PAR 38 METAL HALIDE	000			

FITTERS:  
120 VOLTS:  
-DEEP BUSRUN  
-SHALLOW BUSRUN  
-SPEC TRACK  
-BASIC TRACK  
-CANOPY

277 VOLTS:  
-DEEP BUSRUN  
-SHALLOW BUSRUN

240 VOLTS:  
-DEEP BUSRUN  
-SHALLOW BUSRUN  
-SPEC TRACK  
-BASIC TRACK  
-CANOPY

C-CLAMPS:  
LIGHT-DUTY  
-STRAIGHT CORD  
-COIL CORD  
HEAVY-DUTY  
-STRAIGHT CORD  
-COIL CORD  
UNISTRUT®

BUS FITTER OPTIONS:  
SWITCH  
ROTATION LOCK

LAMPS:  
PAR38 METAL HALIDE  
70-WATT ANSI CODE M139, M143, M98  
100-WATT ANSI CODE M140, M90

FINISHES:  
MB: BLACK  
P: WHITE  
NT: BRUSHED ALUMINUM  
CP: CUSTOM FINISH

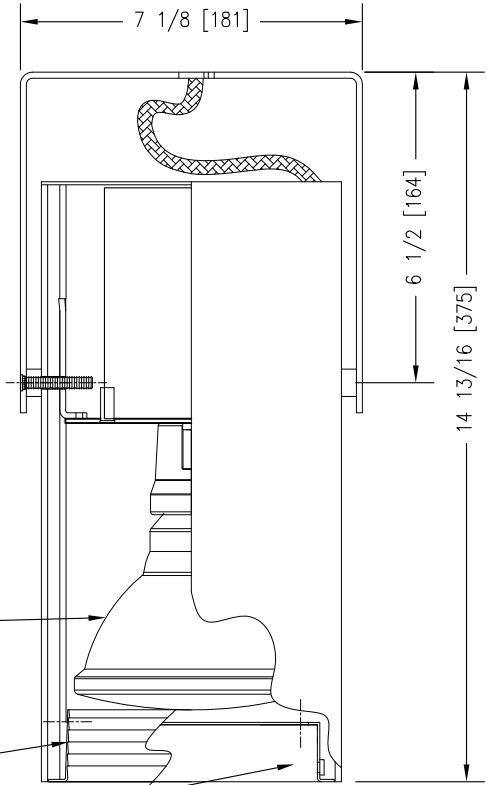
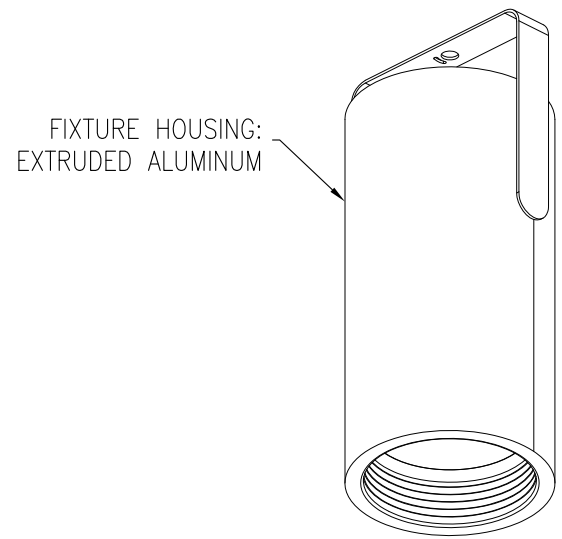

PAR38 METAL HALIDE LAMP  
(ordered separately)

GROOVED BLACK BAFFLE  
or  
OPTIONAL  
ACCESSORY HOLDER

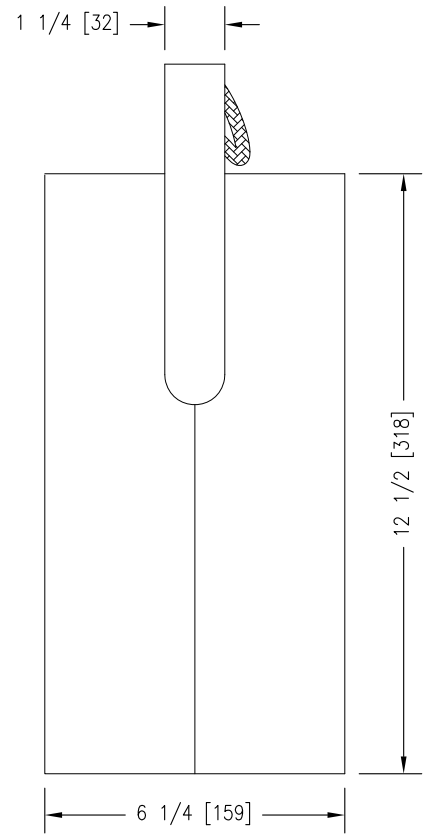

ACCESSORIES:  
SIZE CODE: "5.125"  
Holds up to three  
Ordered separately

AH - ACCESSORY HOLDER REQUIRED  
FOR ACCESSORIES

LOUVERS AND BAFFLES:  
LVR/5.125      CUBE-CELL LOUVER

BARNDOOR# 60096 MB

